

NEW

Signature 2000 HS SERIES

Redesigned and precision engineered for long term, trouble-free servicing.

The new and improved Signature 2000 HS Series by Pentair STA-RITE® offers a durable and reliable solution for all applications in some of Australia's harshest conditions.

STA-RITE®'s proven SignaSeal™ Staging System incorporated with our unique floating impeller design greatly reduces

problems with abrasives, sand lock-up and dry running. All external components are manufactured using stainless steel, coupled with self-lubricating bearings and impellers. Because of this, the HS Series can move the roughest borewater, in extreme environments, for LONGER.

CONSTRUCTION MATERIAL

DISCHARGE BEARING	Nylatron®
DISCHARGE	Stainless Steel
IMPELLERS	Acetal
DIFFUSERS	Polycarbonate
SUCTION CAP	Polycarbonate w/ Stainless Steel insert

SHAFT END COUPLING	Stainless Steel
INTAKE	Stainless Steel
CABLE GUARD	Stainless Steel
CHECK VALVE	Acetal
SHELL	Stainless Steel

The HS Series offers four core ranges: 50, 70, 90 and 150 Litres/min varying between 0.55-7Kw and 7-30 stages. Designed for heads up to 190m and flow rates up to 220 Litres/min.

Max. Head:	188m
Max. Flow:	219 LPM
Power Rating:	0.55-5.5 Kw
Performance series:	50, 70, 90, 150 LPM series available
Number of stages:	7-30 (model dependent)
Diameter:	98mm
Length:	395-1750mm
Weight:	4-16 Kg
Discharge:	1½" - 2" BSP
Shell:	Stainless Steel



NEW

HS SERIES

SERVICEABLE BOREHOLE PUMPS

DEPENDABLE
PERFORMANCE.
FOR LIFE.

PREMIUM QUALITY INTERNAL CHECK VALVE

Spring-loaded design assures a longer lasting, positive seal to minimise water loss.

CAST STAINLESS STEEL INTAKE

The #1 choice for proven corrosion resistance and durability.

ENCLOSED NYLATRON® BEARING

Resists abrasion, self lubricating for long dry-run capability.

SIGNASEAL™ STAGING SYSTEM WITH UNIQUE FLOATING IMPELLER DESIGN

Tested & proven design that protects motor and internal mechanism from thrust and stress to help assure quiet, long lasting performance.

HARDER-THAN-SAND CERAMIC WEAR SURFACE

Smooths sand and grit to defeat abrasion damage.

LARGE HEXAGONAL SHAFT

Transmits power without wear & flex.

STAINLESS STEEL SUCTION SCREEN

Durability in aggressive water.

300-GRADE HEAVY-WALL STAINLESS STEEL OUTER SHELL

Heavy wall thickness for unbeatable durability and dry-run capability.

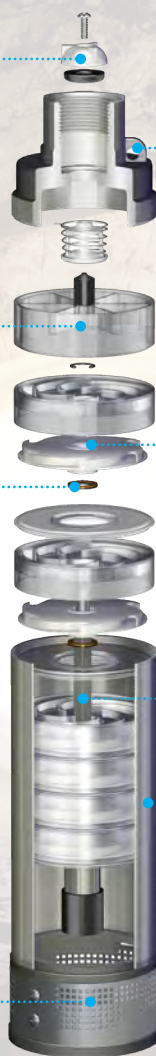

APPLICATIONS



Residential



Industrial



Commercial



Multiple Housing

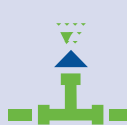

Irrigation



Agriculture



Horticultural

TECHNICAL SPECIFICATIONS

Part number	Nominal hp	Nominal kW	No. of Stages	Pump End approx length in mm	Pump End approx. diameter (mm)	Pump End approx. weight (kg)	Discharge Outlet
50 LITRES PER MINUTE NOMINAL CAPACITY							
5L15P4DH-04	0.75	0.55	7	395	98	4	1½" BSP (female)
5L15P4EH-04	1	0.75	11	510	98	4	1½" BSP (female)
5L15P4FH-04	1.5	1.1	15	620	98	5	1½" BSP (female)
5L15P4GH-04	2	1.5	19	735	98	6	1½" BSP (female)

70 LITRES PER MINUTE NOMINAL CAPACITY							
5L20P4EH-04	1	0.75	8	420	98	4	2" BSP (female)
5L20P4FH-04	1.5	1.1	12	535	98	5	2" BSP (female)
5L20P4GH-04	2	1.5	16	650	98	5	2" BSP (female)
5L20P4HH-04	3	2.2	24	885	98	6	2" BSP (female)

90 LITRES PER MINUTE NOMINAL CAPACITY							
5L30P4FH-04	1.5	1.1	8	485	98	5	2" BSP (female)
5L30P4GH-04	2	1.5	11	595	98	5	2" BSP (female)
5L30P4HH-04	3	2.2	17	815	98	6	2" BSP (female)
5L30P4JH-04	5	3	28	1220	98	9	2" BSP (female)

150 LITRES PER MINUTE NOMINAL CAPACITY							
5L50P4GH-04	2	1.5	8	595	98	6	2" BSP (female)
5L50P4HH-04	3	2.2	12	800	98	8	2" BSP (female)
5L50P4JH-04	5	3.7	20	945	98	11	2" BSP (female)
5L50P4KH-04	7	5.5	30	1750	98	16	2" BSP (female)

PERFORMANCE

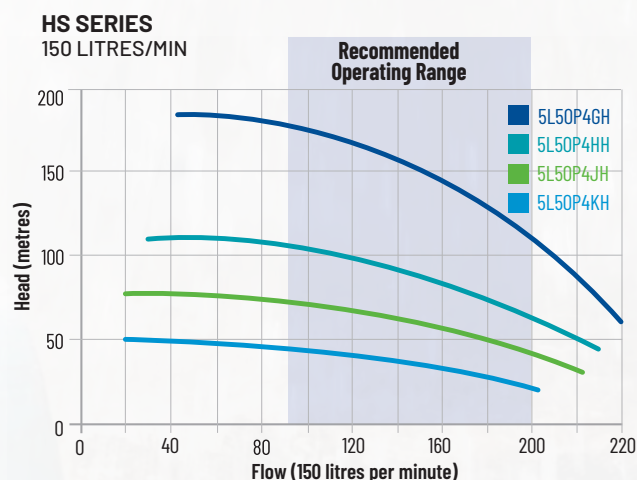
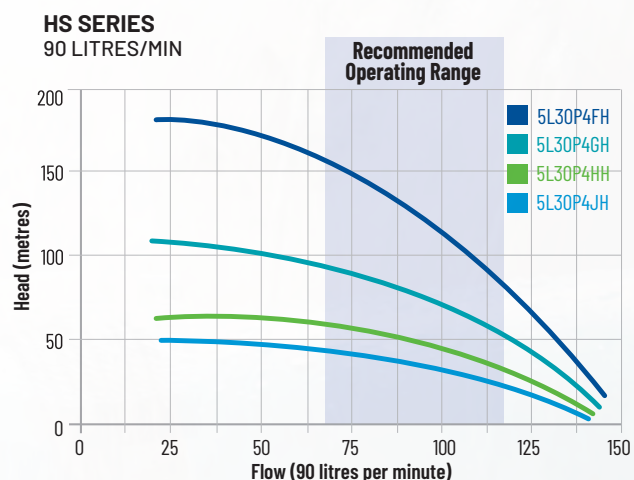
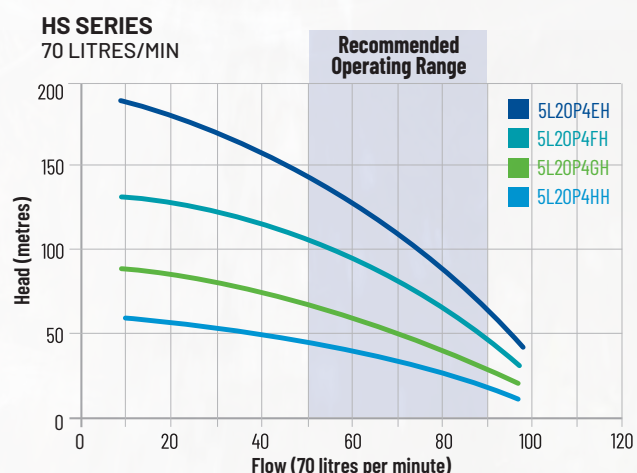
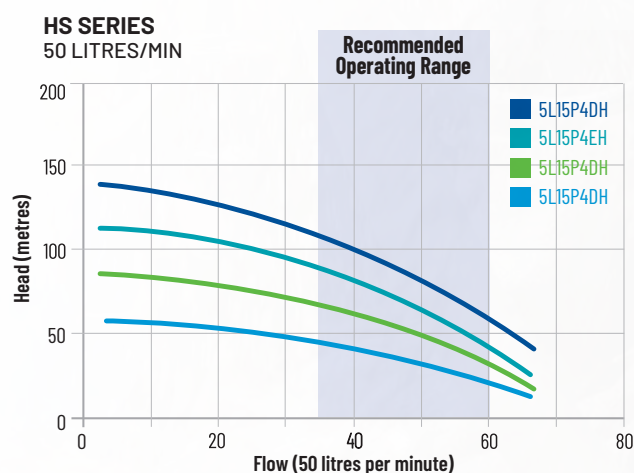



1-21 Monash Drive, Dandenong South, VIC 3175 Australia | 1300 137 344 | pentair.com.au

Information contained here-in remains the property of Pentair Australia Pty Ltd. Any reproduction, display, publication, modification or distribution is strictly prohibited without the prior written permission of Pentair Australia Pty Ltd.

Disclaimer: Pentair reserves the right to change product specifications and products details.
All product images are for reference purposes only and may not represent actual and/or current product.
©2019 Pentair. All rights reserved.